

**WARNUNG**

Gefahr des Verlusts der Text-Bild-Zuordnung beim Ausdruck.

- **Aus technischen Gründen kann derzeit nicht ausgeschlossen werden, dass trotz einwandfreier Darstellung auf dem Bildschirm beim Ausdruck der Zusammenhang von Text und zugehörigem Bild verloren geht.**
- **Wird der Fehler nicht bemerkt, besteht die Gefahr, daß Arbeiten nicht korrekt durchgeführt werden und es dadurch zu Personen- und Sachschäden kommt.**

→ Vergleichen Sie deshalb nach dem Druckvorgang unbedingt die Ausdrücke mit der Bildschirmdarstellung. Korrigieren Sie die Ausdrücke im Fehlerfall so, daß der Inhalt der Bildschirmdarstellung zutreffend wiedergegeben wird.

**WARNING**

Danger of losing text-figure correspondence when printing out.

- **For technical reasons, it can currently not be ruled out that the correspondence between text and associated figure can be lost when it is printed out, even though the display on the screen is correct.**
- **If the fault is not noticed, there is the danger that work will not be performed correctly which can cause injury and damage.**

→ Therefore, always compare printouts with the screen display after printing them out. Correct the printouts if they are faulty so that the content of the screen display matches that on the printouts.

**AVERTISSEMENT**

Risque de perte de la correspondance texte-illustration lors de l'impression papier.

- **Pour des raisons techniques, il ne peut pas être exclu à l'heure actuelle que, même en cas d'affichage correct à l'écran, la correspondance entre le texte et l'illustration puisse être erronée sur l'impression papier.**
- **Si l'erreur passe inaperçue, on court le risque d'exécuter certaines opérations de manière incorrecte pouvant conduire à des dommages corporels et matériels.**

→ Comparez impérativement pour cette raison les impressions papier avec l'affichage à l'écran. Corrigez-les en cas d'erreur de manière à reproduire correctement l'affichage à l'écran.

**ATTENZIONE**

Pericolo di perdita dell'abbinamento testo-immagine nella stampa.

- **Per motivi tecnici non è escluso che, nonostante la rappresentazione sullo schermo risulti perfetta, durante la stampa venga persa la corrispondenza fra testo e relativa immagine.**
- **Se tale difetto non viene rilevato vi è il pericolo che i lavori non siano eseguiti correttamente; ciò può avere come conseguenza lesioni e danneggiamenti.**

→ Per questo motivo, dopo la stampa è assolutamente necessario confrontare le stampe con la rappresentazione sullo schermo. In caso di errore si prega di correggere le stampe, così da garantire la riproduzione esatta della rappresentazione sullo schermo.

**ADVERTENCIA**

Al imprimir se corre el riesgo de perder la correcta asignación de las figuras al texto.

- **Por motivos técnicos, por el momento no se puede descartar que, aun siendo correcta la imagen que aparezca en la pantalla, al imprimir se pierda la correlación entre el texto y la figura correspondiente.**
- **Si este error pasara desapercibido, existe el riesgo de que los trabajos no se ejecuten de forma correcta y, por tanto, se produzcan daños personales y materiales.**

→ Por ello le rogamos que tras el proceso de impresión compare siempre las copias impresas con la imagen de la pantalla. En caso de error, corrija las copias impresas de forma que se correspondan con el contenido de la imagen de la pantalla.

57 30 19 Removing and installing front door sub-frame - as of MY 2003

- [Preliminary work](#)
- [Technical values](#)
- [Removing front door sub-frame](#)
- [Installing front door sub-frame](#)
- [Subsequent work](#)

Preliminary work

Preliminary work

1. Remove door handle → Removing door handle.
2. Remove front door trim → Removing and installing front door trim.
3. Remove rear-view mirror → Removing and installing rear-view mirror.

Technical values

Tightening torques

Location	Illustration	Thread	Tightening torque [Nm] (ftlb.)
Fastening screw for securing door unit carrier to basic door frame	-9, 11-	M8 x 42.5	33 (24) ± 3 (2)
Fastening screw for securing door unit carrier to basic door frame	-8-	M6 x 16	8 (6) + 2 (1.5)
Fastening screw for securing door lock to basic door frame	-3-	M8 x 14	20 (15) - 2 (1.5)

Test and adjustment values



Note

- The figures showing the gap dimensions can be found in the section entitled → *Diagram of gap dimensions.*

Designation	Dimension	Note
Mirror surround to roof trim strip	-c- 3 mm	
Door window to trim strip or outer side section	-f- 5 mm	

Removing front door sub-frame

Removing front door sub-frame

Installation Location:

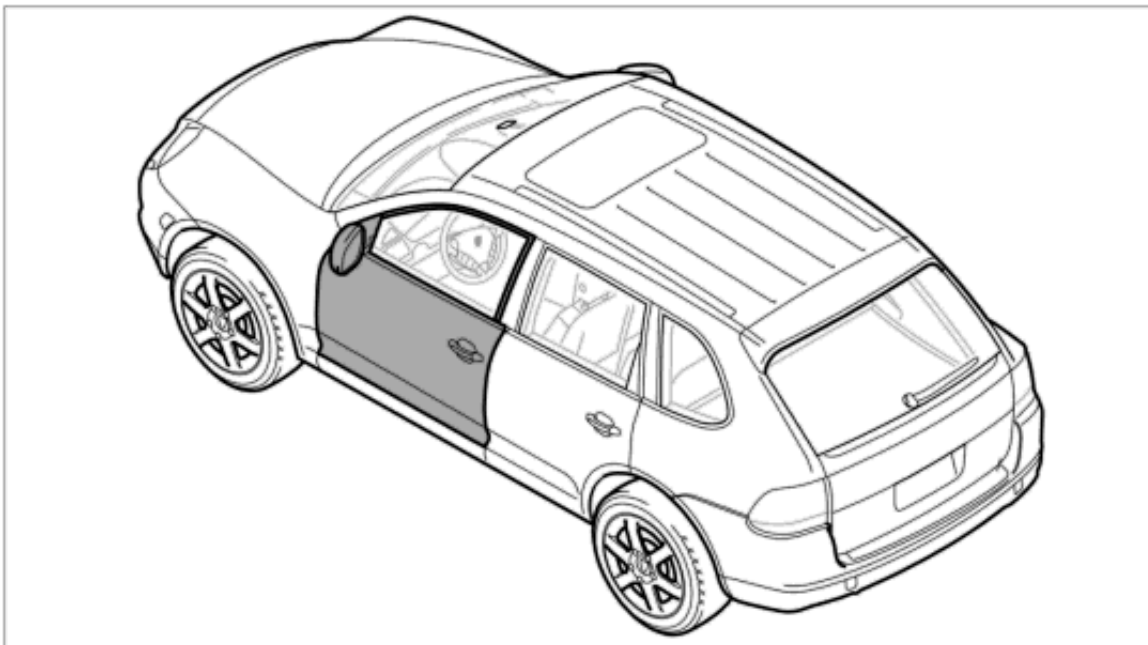

Note

- Close the door window in order to improve accessibility to the door wiring harness when removing the front door unit carrier.
1. Removing rear assembly opening covers, loosening lock mounting and KESSY wiring harness - **For all vehicles:**
 - 1.1. Unclip the top and bottom assembly opening covers **-1-** and **-2-**.

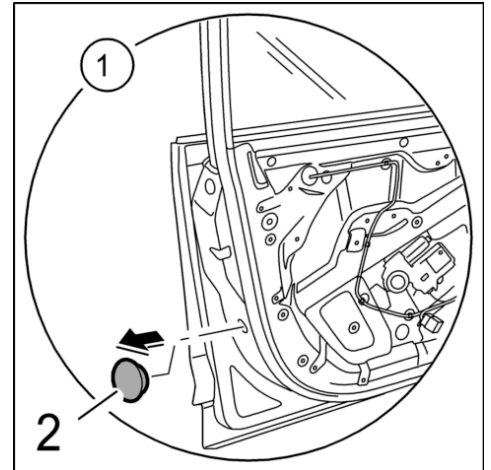
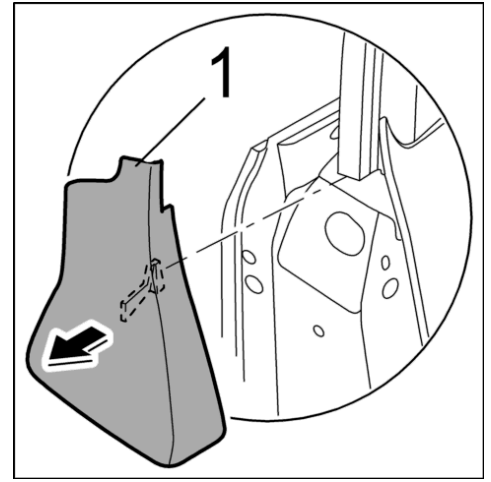

1.2. Unscrew fastening screws **-3-** on door lock.

2. **Also for vehicles with KESY control module:**

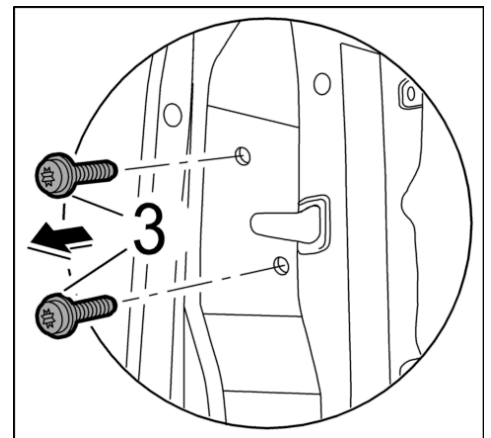

2.1. Release **-Arrow A-** and remove **-Arrow B-** electric connector.

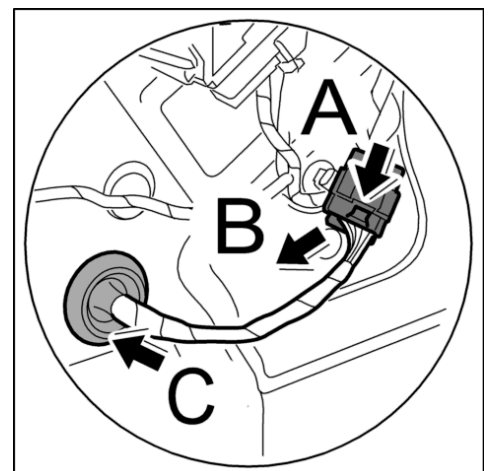

2.2. Press out rubber sleeve **-C-** and slide cable outwards through the opening.

3. Removing front assembly opening covers and disconnecting electrical connection

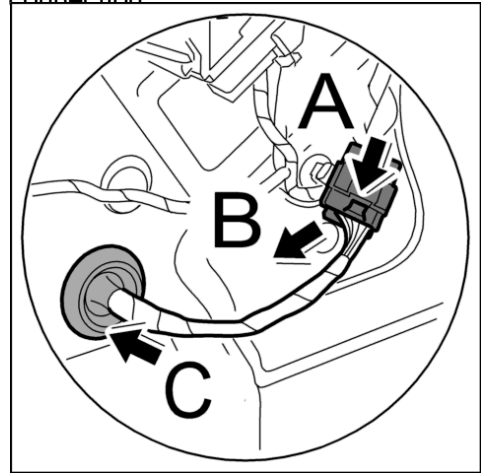

3.1. Unclip the top and bottom assembly opening covers -4- and -5- .

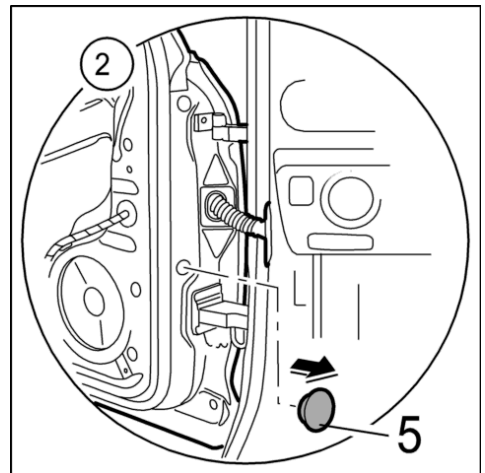
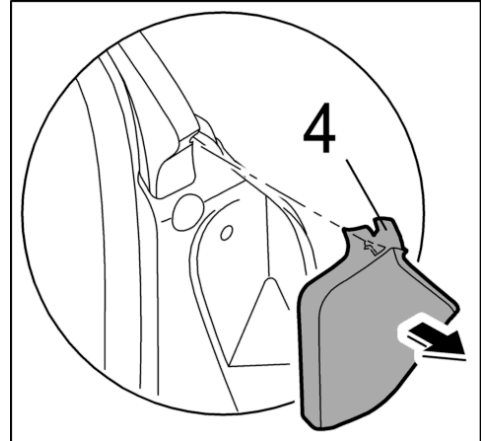

3.2. Pull off rubber sleeve -7- between the door and A-pillar.

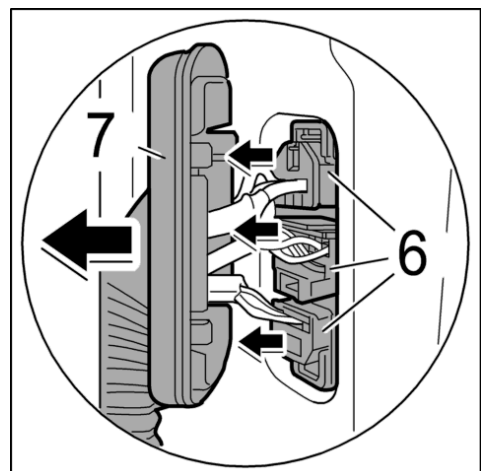

3.3. Release and disconnect electric push-on connectors -6- .

4. Releasing door sub-frame

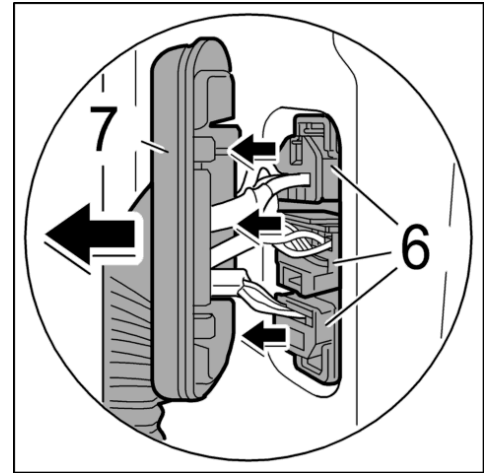

4.1. Unscrew fastening screws for door sub-frame -8, 9- and -11- .

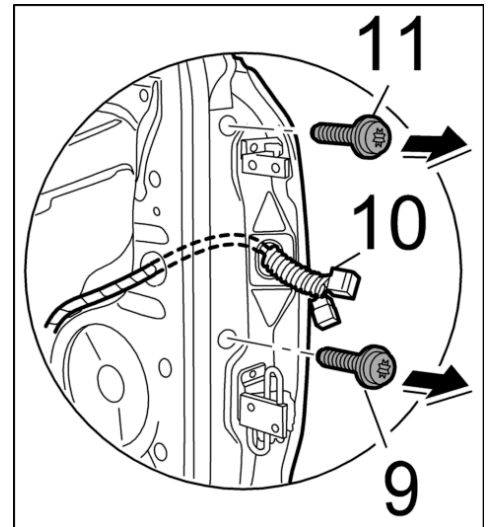
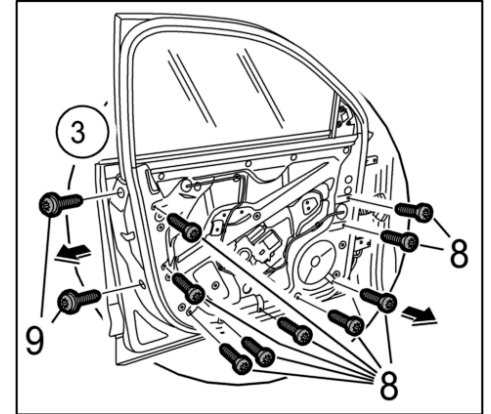

4.2. Press rubber sleeve on the wiring harness -10- inwards and remove wiring harness -10- through the door opening and the door sub-frame.

5. Removing door sub-frame

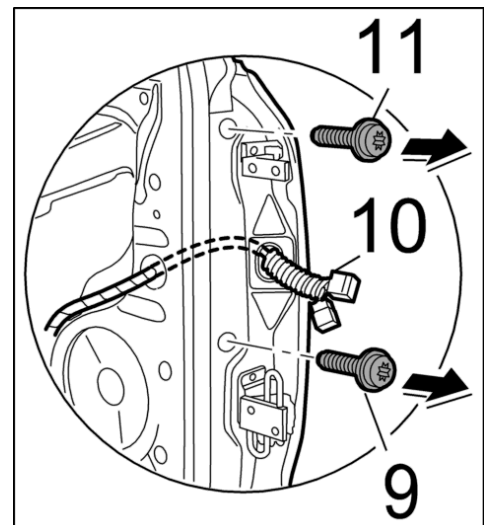

- 5.1. Raise the door sub-frame **-12-** evenly at the front and rear until the guide pins **-13-** and **-16-** are fully released from the holding slots **-14-** and **-15-**.

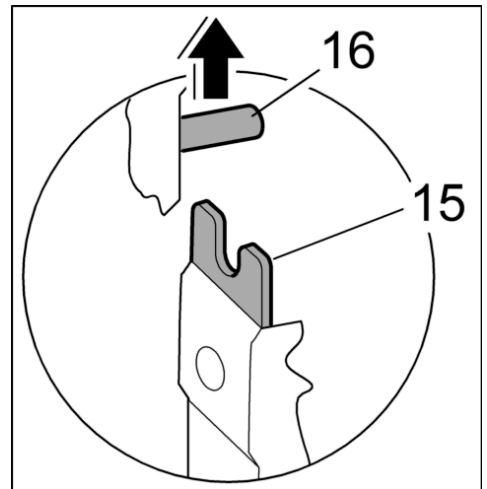
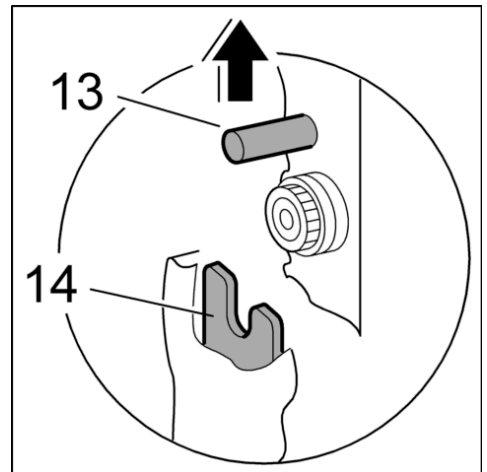
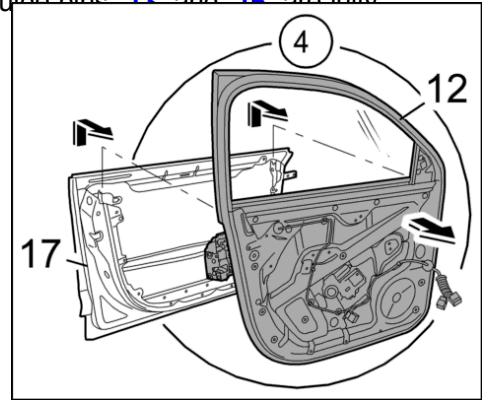

- 5.2. Remove the door sub-frame from the basic door frame **-17-**.

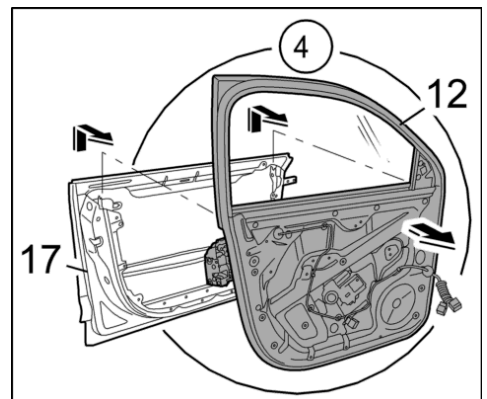

Installing front door sub-frame

Installing front door sub-frame

Installation Location:

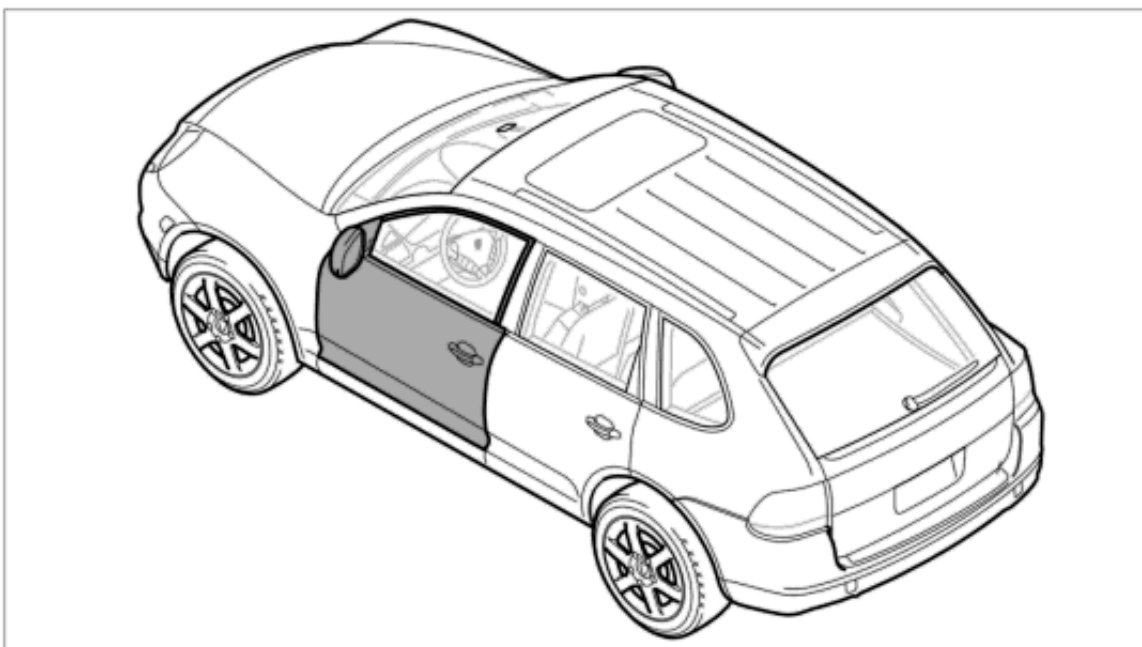

1. Moving adjustable fastening elements to their home position

- 1.1. Move the three adjustable fastening elements (**-Arrow A, B, C-**) on the door sub-frame to their home position. Screw the screw element **-19-** fully into the basic element **-18-** .



Note

The screw elements have left-handed threads.

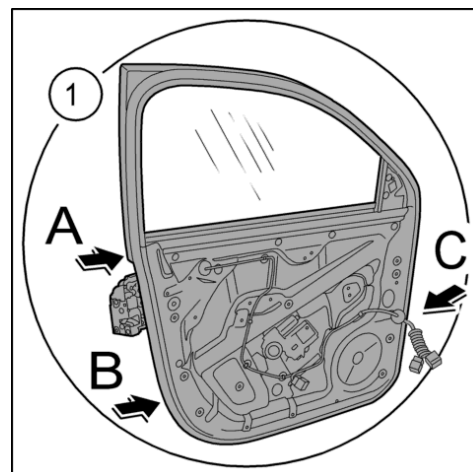

2. Opening basic door frame

3. Engaging door sub-frame on basic door frame

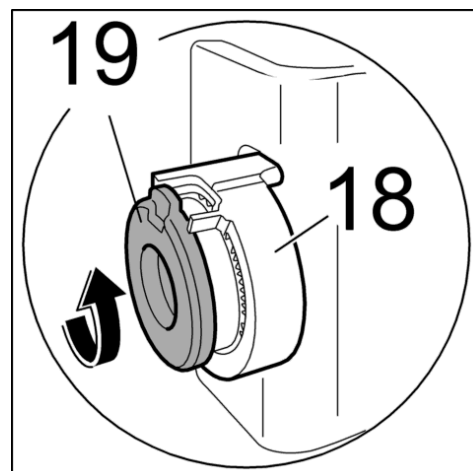

- 3.1. Mount the door sub-frame **-12-** on the basic door frame **-17-**.

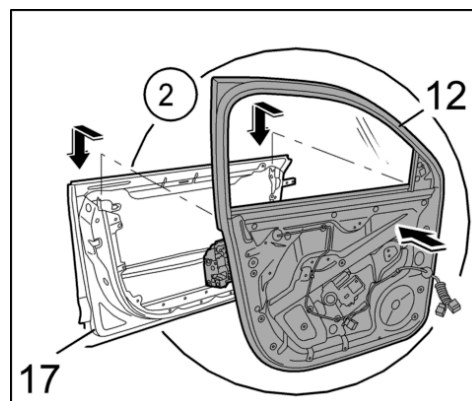

- 3.2. Insert guide pins **-13-** and **-16-** into the holding slots **-14-** and **-15-**.

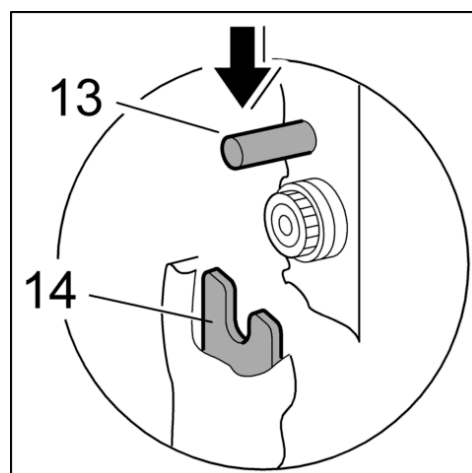

4. Fixing door sub-frame to basic door frame, linking up electrical plug connection and tightening lock

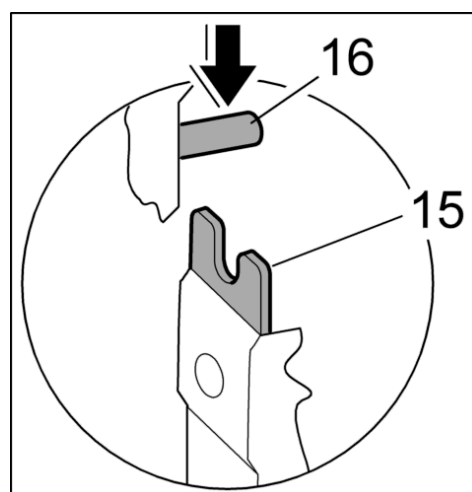

- 4.1. Fix the door sub-frame to the basic door frame by screwing in the fastening screws **-9,** **11-**. Press the door sub-frame upwards and screw in fastening screws slightly.

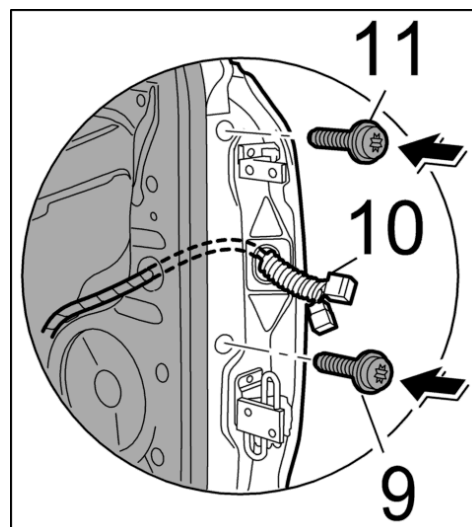

- 4.2. Push wiring harness **-10-** from inside through the door sub-frame and the door opening and press rubber

sleeve on the wiring harness **-10-** from inside into the door opening.

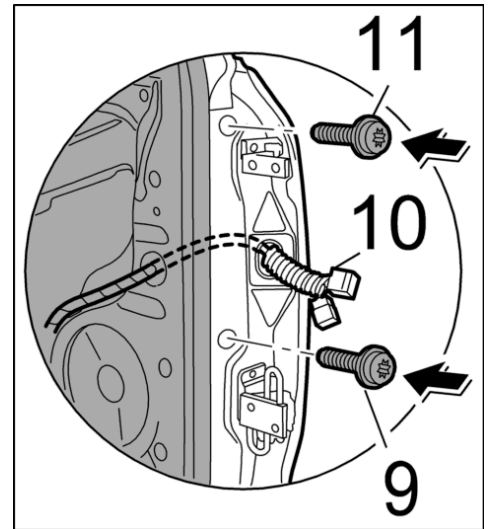

4.3. Connect electric push-on connector **-6-**.

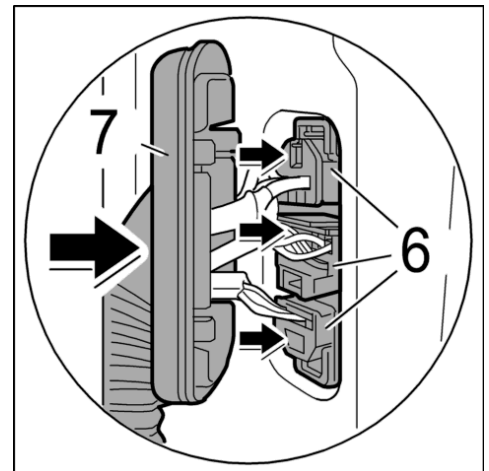

4.4. Press on the rubber sleeve **-7-** between the doors and A-pillar.

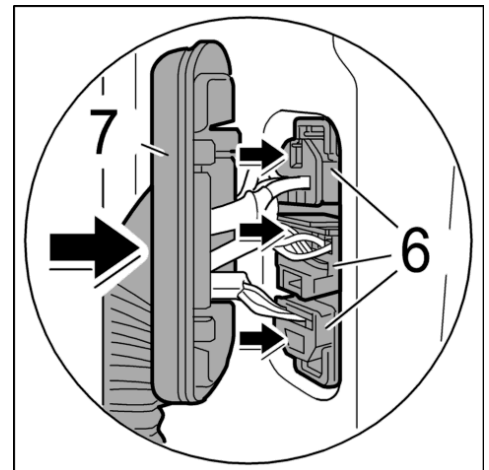

4.5. Screw in new fastening screws **-3-** on the door lock and tighten to the specified tightening torque → Tightening torques.

5. Adjusting door sub-frame

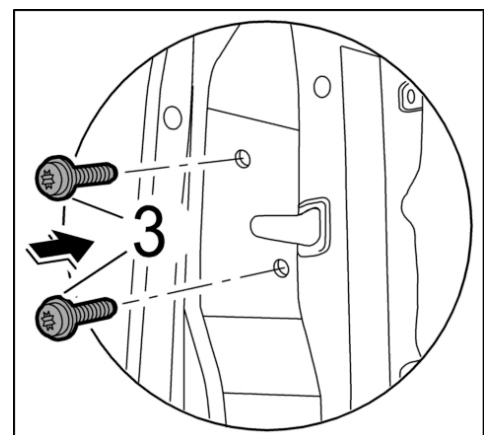

5.1. The fastening screw **-11-** secures the front bearing position (holding slot **-15-** for guide pin **-16-**). This

bearing point cannot then be adjusted!

5.2. Close the door carefully.



Note

The setting is achieved by bracing the door unit carrier with the basic door frame using the adjustable fastening elements. If the required joint measurements cannot be achieved, it may be necessary to unscrew the fastening screws **-9,11-** and reset the adjustable fastening elements to the basic position.

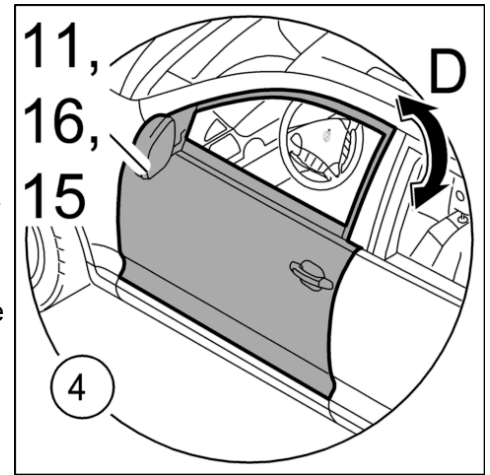

5.3. The window frame (door sub-frame) must be adjusted with respect to the roof frame and B-pillar (**-arrow D-**). The pivoting points in this case are the holding slots **-14-** , **-15-** and the guide pins **-13-** , **-16-** . Adjust the gap dimensions on the door sub-frame.

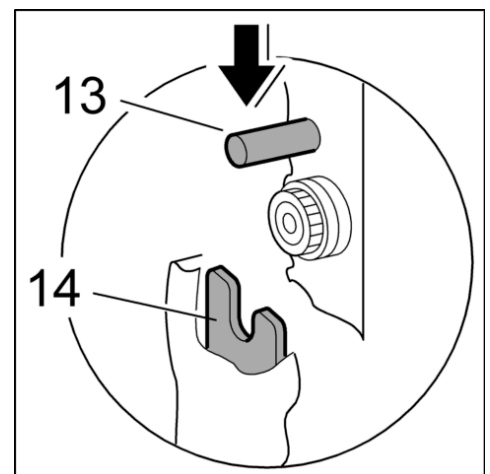
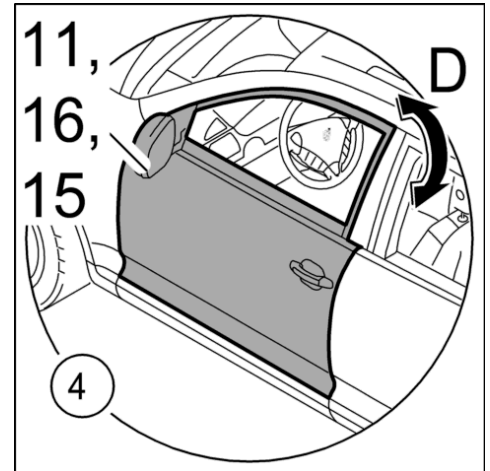

5.4. → Test and adjustment values

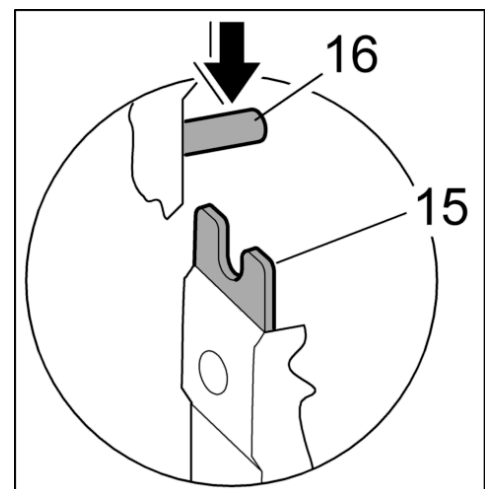

5.5. Tighten fastening screws **-9, 11-** to the specified tightening torque. → Tightening torques

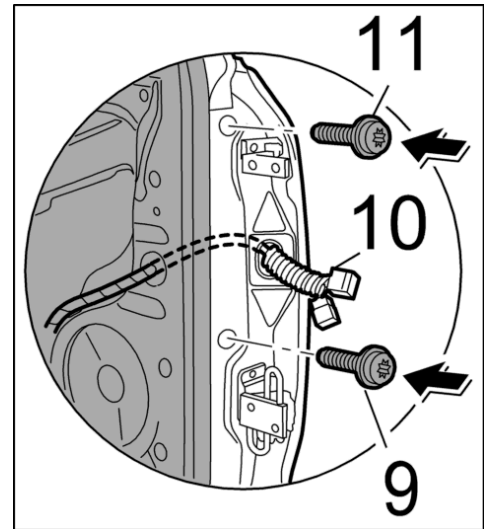

6. Fastening door sub-frame

- 6.1. Screw in fastening screws **-8-** and tighten to the specified tightening torque.
 → Tightening torques

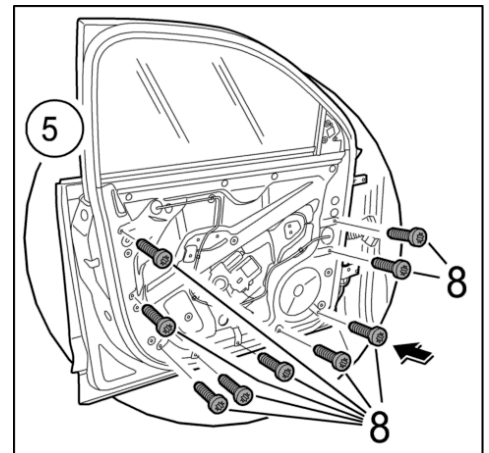

Installation Location:

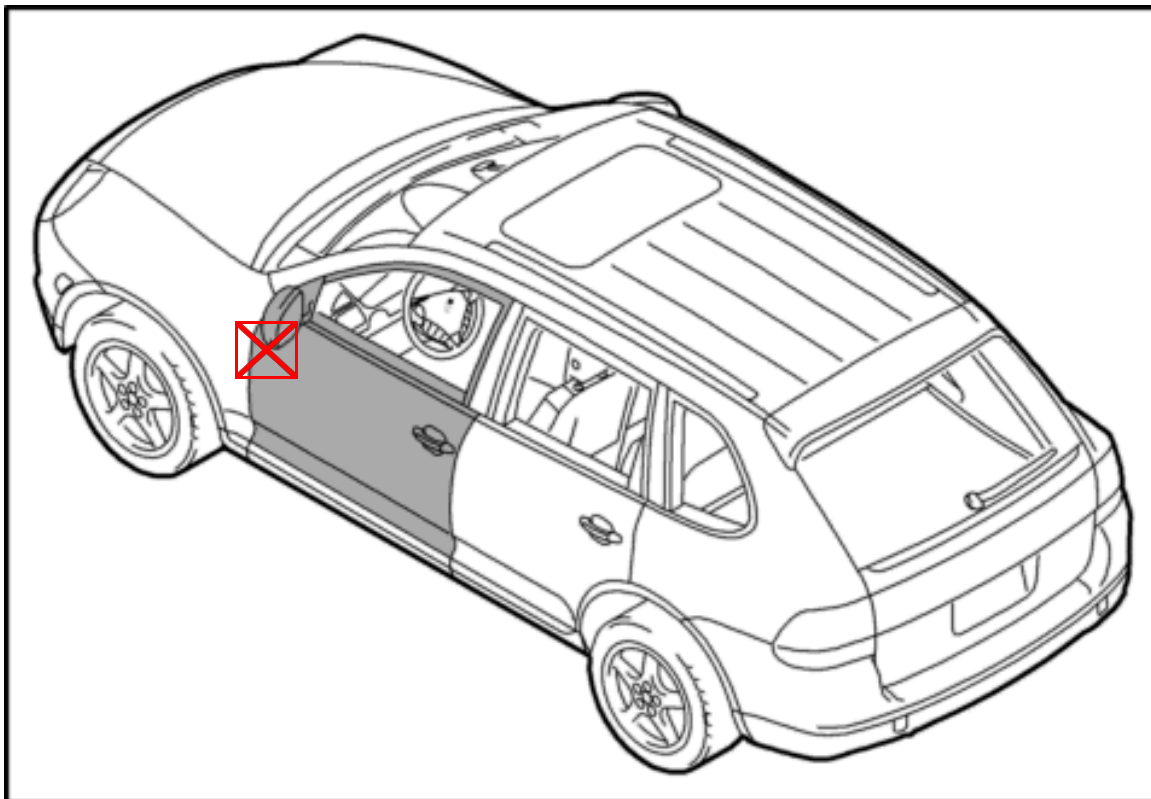

7. Clipping in covers of front assembly openings

7.1. Clip in the top and bottom assembly opening covers **-4-** and **-5-**.

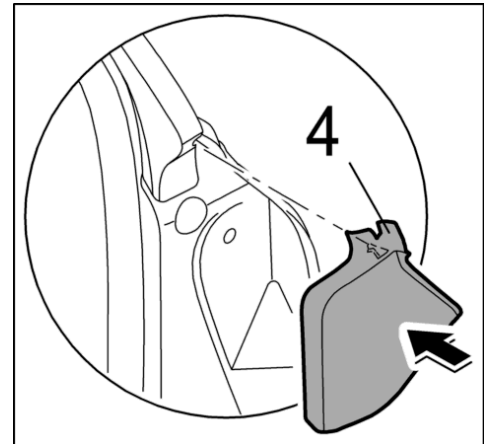
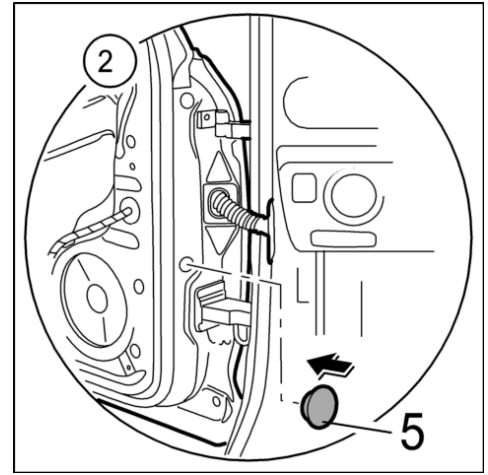

8. Clipping in rear assembly opening covers and connecting KESSY wiring harness - **For all vehicles:**

8.1. Clip in the top and bottom assembly opening covers **-1-** and **-2-**.

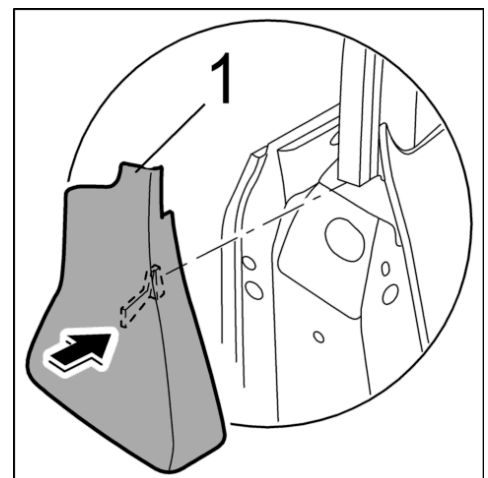
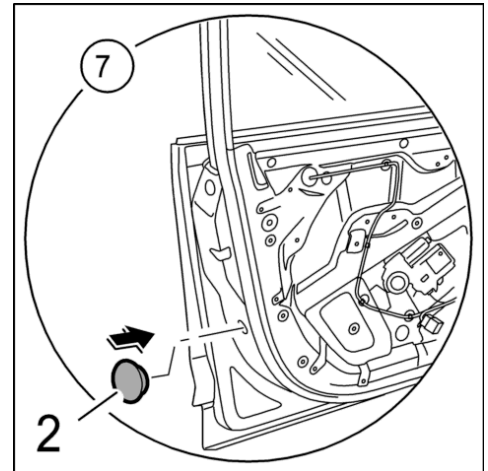

9. **Also for vehicles with KESSY control module:**

- 9.1. Pull KESSY wiring harness in through the opening. Install rubber sleeve in the unit carrier until it engages completely (**-Arrow A-**).
- 9.2. Insert plug into the socket (**-Arrow B-**) until it clicks into place.

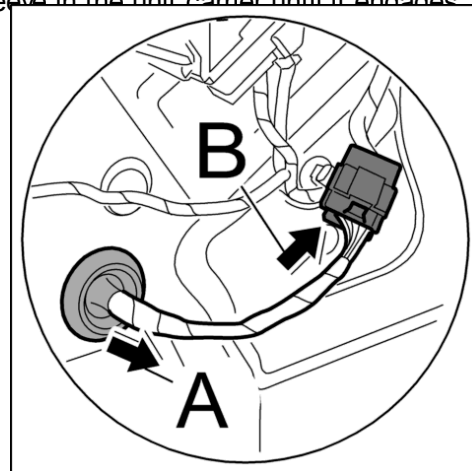

Subsequent work

Subsequent work

1. Install rear-view mirror → Removing and installing rear-view mirror.
2. Install front door trim → Removing and installing front door trim.
3. Install door handle → Installing door handle.
4. Teach power windows → Work instructions after disconnecting the battery.

9PAAD1, 9PAAD7, 9PAAE1, 9PAAE7, 9PAAF1, 9PAAJ1

as of MY 2003

Country C00, C02, C05, C07, C08, C09, C10, C11, C12, C13, C14, C15, C16, C18, C19, C20, C21, C22, C23, C24, C25, C26, C27, C28, C32, C33, C34, C35, C36, C37, C38, C39, C45, C46, C98, C99